



Telescopic Arm For Bucket Digging Foundation House Red Hitachi

Our Product Introduction

Basic Information

- Place of Origin: Guangdong Province, China
- Brand Name: Kaiping Zhonghe Machinery Manufacturing Co. Ltd
- Certification: CE, patent, ISO
- Model Number: HB0019
- Minimum Order Quantity: 1 set / piece
- Price: USD 139.00-USD6999.00
- Packaging Details: bubble / wooden cases / others as you request
- Delivery Time: 10-20/works
- Payment Terms: T/T, L/C
- Supply Ability: 5 sets per week

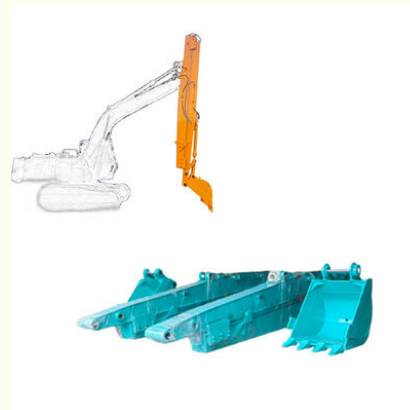

Product Specification

- Long Reach: 10M 12M 16M
- Material: Q355B Or Q690D Or As You Request
- Quality: Premium
- High Effective: Yes
- Warranty: 6 Months For The Arm And Cylinder, 3 Months
- After-sales Service: 24h
- Highlight: House Foundation Telescopic Arm, Red Hitachi Telescopic Arm, Bucket Digging Telescopic Arm



More Images



for more products please visit us on excavatorlongarm.com

Product Description

10M for Excavator Telescopic Boom Telescopic Arm Hitachi Komatsu Sany Cat Zoomlion

Introduction of **Excavator Telescopic Boom Telescopic Arm**:

A telescopic excavator is a highly adaptable piece of heavy machinery suited for a variety of excavation tasks. Its standout feature is the extendable arm, which enables operators to access greater distances and depths compared to conventional excavators. This versatility makes it perfect for numerous applications, including construction, landscaping, and utility work. The ability to adjust the arm to different lengths enhances flexibility and efficiency, especially in confined or difficult workspaces.

Beyond their impressive reach, telescopic excavators incorporate advanced hydraulic systems that facilitate smooth and precise maneuvering. This technology allows operators to execute tasks with increased control and accuracy, whether they are digging, lifting, or transporting materials. The synergy of extended reach and sophisticated hydraulics not only boosts productivity but also enhances safety on job sites by allowing operators to maintain a safe distance from hazardous areas, minimizing the risk of accidents.

Highlights of Kaiping Zhonghe Machinery's **Excavator Telescopic Boom Telescopic Arm**:





Strews
Available



its easy for the
pipeline jumps
up, causing
damage to the
pipeline.



Welded on, less
vibration and
longer service
life.



Double limit design
reduces cylinder over pulling
and jitter



Huge vibration
cylinder easy to fail

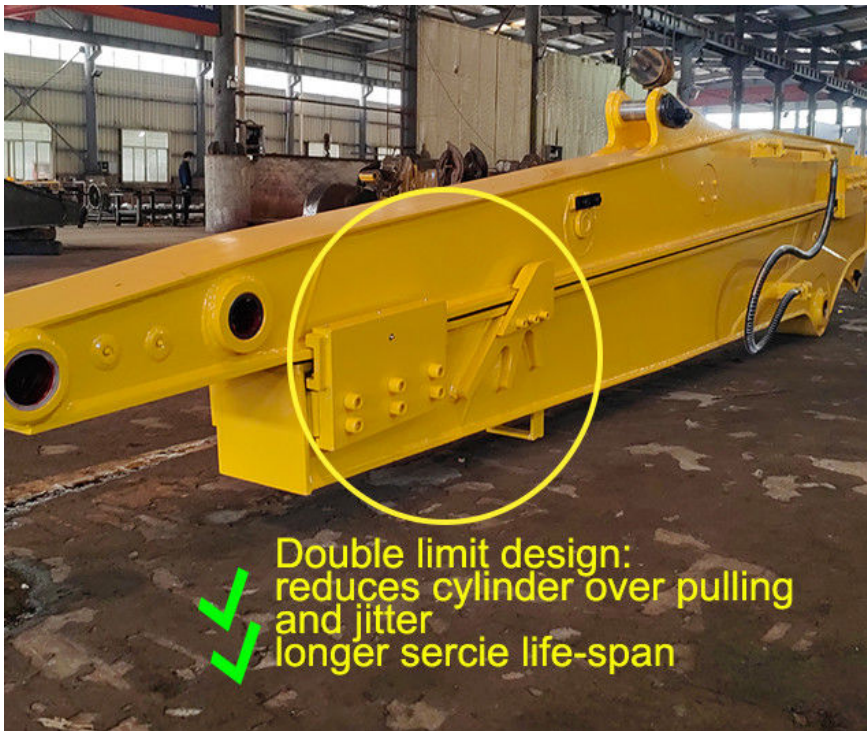

Double limit design:
reduces cylinder over pulling
and jitter
longer scissor life-span

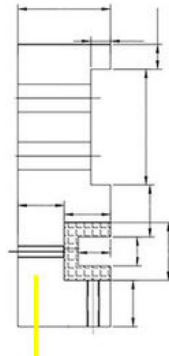

Thicken
Reduce cracking and failure rate



Longer service life-span



Easy to fail and crack



Top Picks of Excavator arms and booms:



Telescopic Arm



Three-section Telescopic Arm



Tunnel Arm / Shorten Arm



Pile Arm Pile Boom





Sales Manager

Manufacturer of Excavator Arm and Boom

Whatsapp: +86 13822325403

Email: aria@excavatorboomarm.com
13822325403@163.com

Web: www.excavatorlongarm.com



Jiangmen Kaiping Zhonghe Machinery Manufacturing Co., Ltd



+86 13822325403



aria@excavatorboomarm.com



excavatorlongarm.com

9 Huancui West Road, Cuishanhu New Area, Kaiping City, Guangdong Province, China